

## COLOR-KEYED® MULTI-TAP CONNECTORS

CABLE SIZE: 16 Str to 4/0 AWG

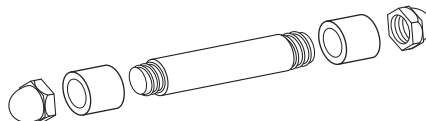

### ⚠ WARNING ⚠

**NEVER ATTEMPT TO MAKE A CONNECTION TO A "HOT" LINE.**

Never assume the power is OFF! Determine beforehand if any electrical hazard exists. Maintain adequate spacing for connections or applications in accordance with all national and local codes.

### GENERAL INFORMATION

The Multi-Tap Connector is made of high conductivity copper, electro-tin plated.

The Multi-Tap Connector includes:

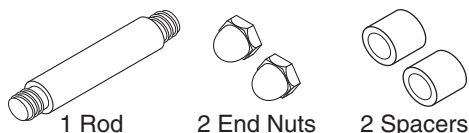

Components Sold Separately:

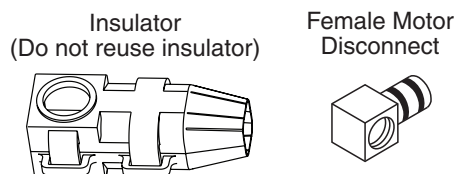

### INSTALLATION INSTRUCTIONS

1. Install Female Motor Disconnect per its installation instructions.



2. Snap appropriate Insulator over Female Disconnect.



3. Remove one End Nut and both Spacers.

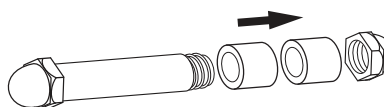

Instructions continued on back page.

### Female Disconnect Chart

Body Size	Wire Size AWG	Female Disconnect
0	#16-14	MD1614F-0
1	#16-14	MD1614F-1
	#12-10	MD1210F-1
	#8 #6	MD8F-1 MD6F-1

Body Size	Wire Size AWG	Female Disconnect
2	#12-10	MD1210F-2
	#8	MD8F-2
	#6	MD6F-2
	#4	MD4F-2
	#2	MD2F-2
3	#1	MD1F-2
	#2	MD2F-3
	#1	MD1F-3
	#1/0	MD10F-3
	#2/0	MD20F-3
	#3/0	MD30F-3
	#4/0	MD40F-3

### Multi-Tap Connector Chart

Body Size	Insulator Cat. No.	2 Position Cat. No.	4 Position Cat. No.	6 Position Cat. No.	8 Position Cat. No.	10 Position Cat. No.	12 Position Cat. No.
0	REC-0	R0-2	R0-4	R0-6	R0-8	R0-10	R0-12
1	REC-1	R1-2	R1-4	R1-6	R1-8	R1-10K	R1-12K
2	REC-2	R2-2	R2-4	R2-6	R2-8	R2-10	R2-12
3	REC-3	R3-2	R3-4	R3-6	R3-8	R3-10	R3-12

4. Slide Disconnect / Insulator Assembly onto Multi-Tap Connector.

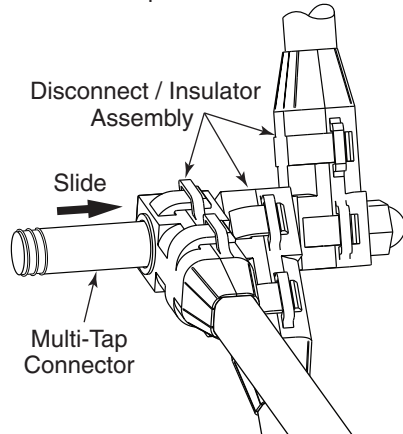

5. If all of the positions are not being used, slide appropriate number of spacers to fill Multi-Tap.

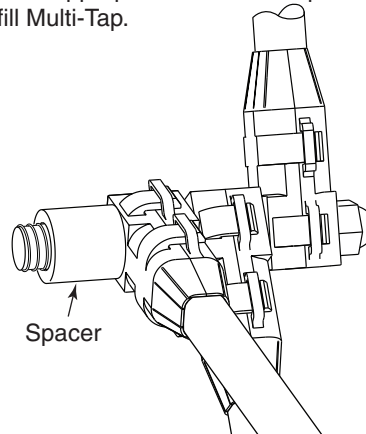

6. Re-apply the End Nut to secure the Multi-Tap and Disconnect / Insulator Assemblies in place. Once the Multi-Tap is secured, the Disconnect / Insulator Assemblies can be rotated to any desired position.

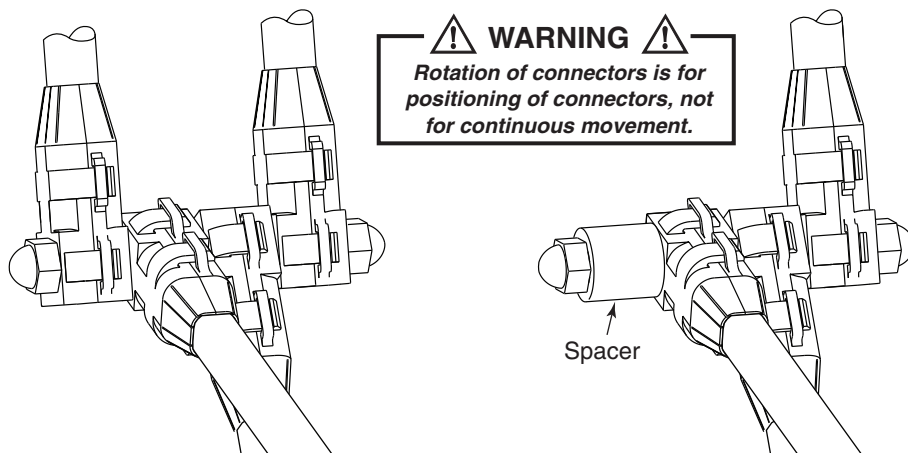

See Multi-Tap Connector Chart on front page for desired Multi-Tap Connector.

**WARRANTY:** Thomas & Betts sells this product with the understanding that the user will perform all necessary tests to determine the suitability of this product for the user's intended application. Thomas & Betts warrants that this product will be free from defects in materials and workmanship for a period of two (2) years following the date of purchase. Upon prompt notification of any warranted defect, Thomas & Betts will, at its option, repair or replace the defective product or refund the purchase price. Proof of purchase is required. Misuse or unauthorized modification of the product voids all warranties.

**Limitations and Exclusions:** THE ABOVE WARRANTY IS THE SOLE WARRANTY CONCERNING THIS PRODUCT, AND IS IN LIEU OF ALL OTHER WARRANTIES EXPRESS OR IMPLIED, INCLUDING BUT NOT LIMITED TO ANY IMPLIED WARRANTY OF MERCHANTABILITY OR FITNESS FOR A PARTICULAR PURPOSE, WHICH ARE SPECIFICALLY DISCLAIMED. LIABILITY FOR BREACH OF THE ABOVE WARRANTY IS LIMITED TO COST OF REPAIR OR REPLACEMENT OF THE PRODUCT, AND UNDER NO CIRCUMSTANCES WILL THOMAS & BETTS BE LIABLE FOR ANY INDIRECT, SPECIAL, INCIDENTAL OR CONSEQUENTIAL DAMAGES.

Thomas & Betts Corporation  
Memphis, Tennessee  
In Canada, Thomas & Betts Ltd., Iberville, P.Q.  
Website: [www.tnb.com](http://www.tnb.com)